



GEORGIA STATE

No. 1

Best Value School, *National Jurist*
and *preLaw Magazine*, Fall 2017

No. 2

Student Loan Hero, May 2017

2

National Mock Titles, *William Daniel National Trial Competition* and *Mockingbird Challenge*, Fall 2017

No. 3

Health Law Program, *U.S. News & World Report*, Spring 2018

No. 10

Part-Time Program, *U.S. News & World Report*, Spring 2018

No. 17

Top Public Law School, *Business Insider*, July 2016

No. 31

Clinical Education Program, *U.S. News & World Report*, Spring 2018

No. 33

Above the Law Top Law Schools, Summer 2017

No. 65

U.S. News & World Report Best Law Schools, Spring 2018

6.4:1

Student: Faculty Ratio
for 2017–18

Order of the Coif

legal honor society



BAR PASSAGE RATE

July 2017: **84.5%**

February 2017: **70.6%**

Student Organizations & Co-curriculars

Georgia State Law has more than 25 student organizations and co-curriculars, including:

- Black Law Students Association
- Intellectual Property Law Society
- Hispanic Student Bar Association
- *Georgia State University Law Review*, compiler of the *Peach Sheets*, which documents the legislative history of selected bills in the Georgia General Assembly
- Mindfulness in Law Society
- Moot Court
- OUTLaw
- Pro Bono Program
- Public Interest Law Association
- Student Bar Association
- Student Health Law Association
- Student Trial Lawyers Association (mock trial program)

law.gsu.edu/student-orgs

Contact Us

Admissions
lawadmissions@gsu.edu
404-413-9200

Alumni Relations
lawdevelopment@gsu.edu
404-413-9020

Center for Professional Development & Career Strategies
lawcso@gsu.edu
404-413-9070

In Person
85 Park Place NE, Atlanta, GA 30303

2017–18 ENTERING CLASS PROFILE

Total Applicants	1,879
Enrolled	190
Average Age	25
Men	91 (48%)
Women	99 (52%)
Minority Enrollment	60 (32%)
Part-Time Students	45
Full-Time Students	145

PERCENTILE	LSAT	GPA
25%	154	3.24
Median	157	3.50
75%	159	3.65

STUDENT BODY TOTALS

Total Students	617
Men	302 (49%)
Women	315 (51%)
Minority Enrollment	210 (34%)
Part-Time Students	147
Full-Time Students	470

Our alumni are an integral part of the extended Georgia State Law community, which opens pathways for important research and creative collaborations. Your connection to Georgia State Law doesn't end with graduation. As an active member of our alumni community, you make a direct positive impact on our college.

Some Georgia State Law alumni partner with faculty to enhance classroom curriculum, others return to campus for a speaking engagement or to volunteer for on-campus interviews or job fairs. With your help, our students are better prepared to enter the competitive legal job market.

Get Involved!

There are many great opportunities for you to be plugged in, from classroom visits and mentoring to being a STLA coach or admissions ambassador in your region.

CONTACT

Anne Hopkins
Director of Development

404.413.9020
abhopkins@gsu.edu

Tower to the Trenches, CLE Series

Tower to the Trenches, is a monthly CLE series, including one hour of either ethics or professionalism training, dedicated to Georgia State Law alumni. The monthly sessions will be led by Georgia State Law faculty and alumni who are experts in specific practice areas.

The program features a 40-minute faculty presentation, 60-minute panel discussion, and 20-minute question and answer session with faculty, panel and attendees.

Times and Dates

Each session is on the last Friday of the month, unless noted, beginning at 9 a.m. Light refreshments will be served on **April 27**.

Registration: The cost is \$50, which covers the CLE credits and other incidentals.

Learn more at law.gsu.edu/tower

Alumni Receptions

Georgia State Law hosts several alumni receptions throughout the year to connect classmates, friends and family. Receptions are usually held in early fall, winter and spring at local restaurants or pubs.

Reconnect with your classmates and network. Dates and location are posted on social media and sent out via email so be on the lookout. We hope to see you at the next one!

Upcoming Receptions

May 17: Alumni Networking Reception

June 8: Alumni Networking Reception at the State Bar of Georgia Annual Meeting at Amelia Island, Florida



CONTACT

Ely Abbott
Assistant Dean of Development

404.413.9022
Planned Giving and Locker Campaign
ely@gsu.edu

Anne Hopkins
Director of Development

404.413.9020
Tower to the Trenches and Law Firm Campaign
abhopkins@gsu.edu

Make a Difference

Planned Giving

Georgia State Law accepts charitable annuities, investment options, planned gifts through trusts, wills and estates, and other options.

Contact **Ely Abbott**, assistant dean of development, at 404-413-9022 to discuss a method that works best for you.

Law Firm Campaign

The Law Firm Campaign is a friendly competition among firms and companies that reconnects alumni to Georgia State Law and promotes involvement in the college's annual campaign. Participating firms and companies have an agent(s) who encourage colleagues to make a gift to the Fund for Law that's equivalent to "one billable hour."

The campaign:

- increases law alumni participation in the annual campaign
- provides financial resources to the college
- re-engages law graduates in their school

Firms are placed in divisions, based on number of alumni employed at the firm. Those firms with the highest percentage of alumni participation, or which raise the most contributions are recognized for these extraordinary efforts. The firm that exhibits meaningful and proportionate participation will take home the Law Firm Campaign's Most Valuable Participant award.

For more information or to become participating member, contact **Anne Hopkins**, director of development, at 404-413-9020.

Locker Campaign

Leave a Lasting Mark. Name a Locker.

Do you remember your law school locker? The only place where you could unload the heavy burden of Contracts or Civil Procedure? The place where you and your friends would celebrate a successful Mock Trial or Moot Court competition?

Now, you can leave a lasting legacy with a gift in honor of your law school memories. For \$1,000, your name will become a permanent part of 85 Park Place, with a locker plate.

Your investment and support will help sustain and enhance the College of Law so we can provide better access and more hands-on learning that will enable bright, deserving students from all backgrounds to emerge from their law study ready to make a difference in the profession, in Atlanta and the nation.

With a new home designed to support 21st-century legal instruction, Georgia State Law needs your help for the college to burn brighter.

Contact **Ely Abbott**, assistant dean of development, at 404-413-9022 or visit law.gsu.edu/lockercampaign to secure your locker.





Our Center for Professional Development & Career Strategies combines innovation and deep experience to deliver truly customized career service. This proactive approach begins the first semester as our first-year students participate in our Professional Development class, which establishes an essential foundation for career success.

Center for Professional Development and Career Strategies

The First Year

The Professional Development Program includes creation of a unique narrative and effective materials that clearly define a personal brand, introduction to an array of career options, interview preparation and skill, as well as networking guidance. The class culminates with a one-on-one counseling session with an experienced member of our career development team, where we continue to build an authentic relationship and essential insight into the specific employment goals of each student.

Counseling session highlights include mock interviews, and detailed discussion of the extensive externship and clinical offerings available through the law school. The result is a student who is prepared and confident for his or her first foray into campus interviews, numerous job fairs, internships and summer employment.

Second and Third Years

Upper-level and part-time students enjoy the same customized attention and gain additional benefit from elevated programs, networking events and informational interviews as they continue to explore career paths. Our open-door policy helps ensure students drop in with quick questions or updates. Students are encouraged to schedule individual appointments that fit their busy schedules.

Post Graduation

Our efforts do not stop once students land their first post-graduate job. **The Center for Professional Development & Career Strategies** team has deep lateral recruiting experience and is well prepared to actively assist and support our alumni with any career transition. With vast knowledge and connections, helping our alumni make the right introduction is in the center of our wheel house.

Once a Georgia State Law attorney, always a Georgia State Law attorney. It is an honor and pleasure to have the opportunity to work with each and every student and our alumni.

"As an alumni, I know the value and quality of an education from Georgia State Law. On the interviewer's side of the table, I am continually impressed by the enthusiasm, drive, and talent of the Georgia State Law candidates."

Jennifer Dempsey (J.D. '00)
Former hiring partner, Bryan Cave

CONTACT

Lyn Knapp, Senior Director

404.413.9074
eknapp@gsu.edu

Amy McCarthy, Director

404.413.9072
amccarthy@gsu.edu

What We Offer for Employers

There are a number of ways employers can hire students or graduates of Georgia State Law.

On-Campus Interviews

In the fall and spring each year, we offer dedicated space and time for on-campus interviews. You can meet multiple candidates for your open positions in one convenient location.

Job Postings

Employers can post a job any time on our on-line job board to receive applications from our qualified students and graduates for law clerk or attorney positions.

Short-Term Hiring Assistance and Recruitment Program (S.H.A.R.P.)

Through S.H.A.R.P. employers can access a pool of pre-qualified candidates for short-term projects (usually within 24 hours).

What We Offer for Students

- professional development course for first-year students, including learning about opportunities in a variety of legal sectors, how to write a resume and cover letter, how to research and prepare for an interview, how to conduct a job search, network and more;
- individual career counseling;
- career aids, guides, templates and resources;
- informational interviews;
- resume and cover letter reviews;
- career workshops, forums, panel presentations and networking events;
- online recruiting tool, Symplicity, which enables students and alumni to view job postings, post resumes and register for on- and off-campus interview opportunities and events;
- fall and spring on-campus recruitment programs;
- national and regional on- and off-campus job fairs;
- reciprocity services that allow students and alumni to use other law schools' career services facilities when relocating to another state after graduation.

"I have never been at a school where career advisers would take that level of personal, one-on-one time with a student. I greatly appreciate it, especially knowing how many other students and other responsibilities you both have. It was a great help to me."

Laura Shoop (J.D. '20)

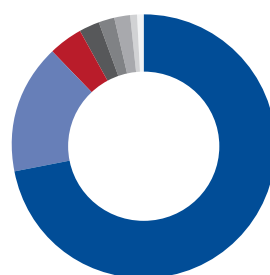

CLASS OF 2016 JOBS: 10 months out

● J.D. Required	72.3%
● J.D. Advantage	16.3%
● Unemployed seeking	4%
● Professional	2.5%
● Graduate studies	2%
● Unemployed not seeking	2%
● Non-professional	0.5%
● Starts after March 15	0.5%

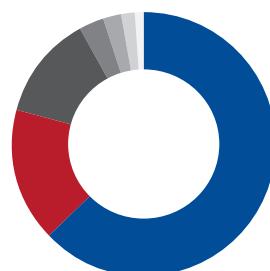

EMPLOYMENT TYPE PROFILE

● Private Practice	62.9%
● Business & Industry	16.4%
● Government	12.7%
● Public Interest	3.2%
● Graduate Studies	2.1%
● Judicial Clerkships	1.6%
● Academia	1.15%

Georgia State Law seeks talented, dedicated and energetic students who will excel in an innovative legal education program that integrates theory with practice. If you know of any talented candidates, let us know and encourage them to apply.

CONTACT: Office of Admissions

404.413.9200

lawadmissions@gsu.edu

In person: 85 Park Place NE, Atlanta, GA 30303

Our Degree Programs

J.D. Juris Doctorate

LL.M. Master of Laws with three tracks:

- General Studies
- BarTrack
- Concentrations in Environmental and Land-Use Law, Health Law and Intellectual Property Law

Additional Degree Options

Dual degrees with Georgia Institute of Technology and within Georgia State University are available for law students seeking interdisciplinary study. Selected coursework in each program satisfies requirements in the other. Dual programs are offered with:

Andrew Young School of Policy Studies

- J.D./M.P.A.: Master of Public Administration

Honors College

- B.A./B.S./J.D.

J. Mack Robinson College of Business

- J.D./M.B.A.: Master of Business Administration;
- J.D./M.P.A.: Master of Professional Accountancy
- J.D./M.S.H.A.: Master of Science and Health Administration
- J.D./M.B.A./M.H.A.: Master of Business Administration and Master of Health Administration

School of Public Health

- J.D./M.P.H.: Master of Public Health

College of Arts and Sciences

- J.D./M.A.: Master of Art in Philosophy

Georgia Institute of Technology

- J.D./M.C.R.P.: Master of Science in City and Regional Planning

Learn more about the College of Law's J.D. and dual degrees at law.gsu.edu/degrees

First-year applicants must apply for the fall term.

To apply, prospective students must submit:

- Application through LSAC with \$50 fee
- Personal statement
- Credential Assembly Service (CAS) Law School Report containing your LSAT scores, undergraduate/graduate transcripts and your recommendation letters



KEY DATES

- **June:** Last month to take LSAT
- **Oct. 1:** Application period opens
- **March 15:** Priority deadline for merit scholarship consideration
- **June 1:** Application period ends

Policies

- First-year J.D. students are accepted for the fall semester only.
- Georgia State Law has a rolling admission policy.
- A bachelor's degree from a regionally accredited college or university is required to register.
- Georgia State Law cannot admit students who are ineligible for readmission to another law school.
- Prospective students must submit all required documents through the Credential Assembly Service of the Law School Admission Council (LSAC).
- Never send documents directly to the admissions office unless requested.
- We do not grant personal interviews.
- For more information, sign up for an information session or class visit.
- The faculty admissions committee reviews files from January until the class is full.
- Full-time students cannot work more than 20 hours per week at any combination of jobs.



BAR CHARACTER AND FITNESS REQUIREMENTS

Every American jurisdiction in which students may practice law after graduation from law school requires each applicant for admission to the bar to meet character and fitness requirements as a condition of eligibility for admission. Students are encouraged, as they go through the law school application process and before they enter law school, to determine the requirements of the jurisdiction(s) where they intend to practice law. If a student is uncertain where he or she will practice law, he or she may wish to review the Standard NCBE Character and Fitness Application, titled Request for Preparation of a Character Report, of the National Conference of Bar Examiners, which is used by a number of jurisdictions' bar admission authorities. Addresses for all relevant agencies are available at ncbex.org.

The Marjorie and Ralph Knowles Conference Center sits in the heart of College of Law's building at 85 Park Place. Through our mission to engage with the community, the college has opened its doors to both Georgia State University and the greater Atlanta area for events and meetings of all kinds.

Featuring a flexible salon-ballroom space, our large Ceremonial Courtroom, as well as a variety of smaller break-out seminar rooms, the center can host events of almost any scale. With up-to-date technology and facilities, the center has been designed from the ground up to be accessible, affordable and flexible. knowlescenter.law.gsu.edu



Knowles Conference Center

College of Law Faculty, Staff and Students

Any Georgia State College of Law faculty or staff member, or any registered student attending classes at the College of Law. This includes any groups affiliated or a part of the College of Law.

Internal Groups

University Departments

Any officially recognized campus department that has a clearly defined connection to Georgia State University and receives university funding.

Chartered Student Organizations

Any student organization that is identified as 'Chartered' through the student organization chartering process. More information can be found at the Office of Georgia State University Student Organizations.

Co-Sponsored Groups

Any non-university entity collaborating with a university department or chartered student organization. The event must be consistent with the missions and goals of the sponsoring university department or organization. A representative of the sponsoring department or organization must serve as the main point of contact and assume responsibility for planning and reconciliation of charges incurred from the event.

Group Sponsorship

The sponsoring Georgia State University department or organization contacts the Knowles Conference Center staff to check date availability. If the space is available, the sponsor will submit a request for space for approval by the Knowles Conference Center director. If approved, the sponsoring department assumes responsibility before, during, and after the event for:

- All event-related costs, including room fees, set-up fees, parking, audio-visual fees, catering, etc.
- Communicating all event needs to the Center
- Having sponsoring departmental staff on-site for the event

External, Non-University or Unaffiliated Groups

An external, non-university or unaffiliated group is defined as any group, organization, corporation or individual with no connection to Georgia State University or an individual or group requesting space for personal use. The individual or group must enter into a contractual agreement with Georgia State for use of space and services by completing a Facilities Use Agreement, set to terms specific to the event. In addition, non-university, unaffiliated, external or co-sponsored events will require valid proof of insurance as outlined in the Facilities Use Agreement.

CONTACT: Nick Fomin
Director of Conference and Event Services

404.413.9280
lawevents@gsu.edu



Knowles Conference Center Rates

ROOM	HALF-DAY INTERNAL	FULL-DAY INTERNAL	HALF-DAY EXTERNAL	FULL-DAY EXTERNAL	LECTURE/ THEATER SET-UP	BANQUET/ RECEPTION SET-UP	CLASSROOM SET-UP	CONFERENCE BOARDROOM SET-UP
Jury Room	\$50	\$75	\$100	\$150	N/A	N/A	N/A	N/A
Ceremonial Courtroom (230 SEAT)	\$200	\$300	\$400	\$600	INCLUDED	N/A	INCLUDED	N/A
Catherine Henson Atrium	\$400	\$500	\$700	\$1,000	N/A	N/A	N/A	N/A
Large Hearing Room	\$200	\$300	\$250	\$400	N/A	N/A	N/A	INCLUDED
Small Hearing Room	\$75	\$100	\$100	\$200	N/A	N/A	N/A	INCLUDED
Faculty Commons	\$100	\$200	\$250	\$400	+\$50	+\$75	+\$50	+\$50
Lecture Hall (90 SEAT)	\$200	\$300	\$350	\$500	N/A	N/A	INCLUDED	N/A
Classroom (50 SEAT)	\$150	\$200	\$250	\$400	N/A	N/A	INCLUDED	N/A
Seminar Room (15–20 SEAT)	\$100	\$150	\$200	\$300	N/A	N/A	INCLUDED	N/A
Breakout Meeting Room (5–10 SEAT)	\$50	\$75	\$100	\$200	N/A	N/A	N/A	INCLUDED
Fifth Floor Terrace	\$200	\$300	\$400	\$500	N/A	+\$50	N/A	N/A
Sixth Floor Terrace	\$300	\$500	\$550	\$700	N/A	+\$50	N/A	N/A
Knowles Conference Center (ONE SALON)	\$100	\$150	\$200	\$250	+\$50	+\$75	+\$100	+\$100
Knowles Conference Center (ALL SALONS)	\$300	\$400	\$600	\$750	+\$150	+\$225	+\$300	+\$300

Rates as of March 22, 2018

Services

Audio/Visual Support

All of our spaces with media capabilities will accept either HDMI or VGA+Stereo-mini line-in inputs. Resolution for presentations should be set to 1920 x 1080 pixels or a 16:9 image aspect-ratio.

The Ceremonial Courtroom and Knowles Conference Center salons are equipped with a podium and integrated media console with a fixed microphone. Additional wireless microphones are available for a fee of \$15 per microphone (limit two per room/section).

On-site audio-visual assistance/service during your scheduled event is available for an hourly fee of \$30/hour. Audio-visual service does not include preparation or modification of presentation materials.

Meeting and Event Equipment

Wireless Access

Wireless connectivity via the Georgia State University on-campus network is available to event guests, 24 hours a day. Sponsoring departments may request guest Internet access for individuals or groups via guestwireless.gsu.edu.

Unaffiliated groups wishing to use the Georgia State guest network will need to submit a complete list of names of all event participants along with access begin and end times.

Catering

The Knowles Conference Center has one preferred caterer, Panther Dining. The Knowles Conference Center office can provide assistance in selecting menu items and quantities, but all catering orders will be submitted by the client directly.



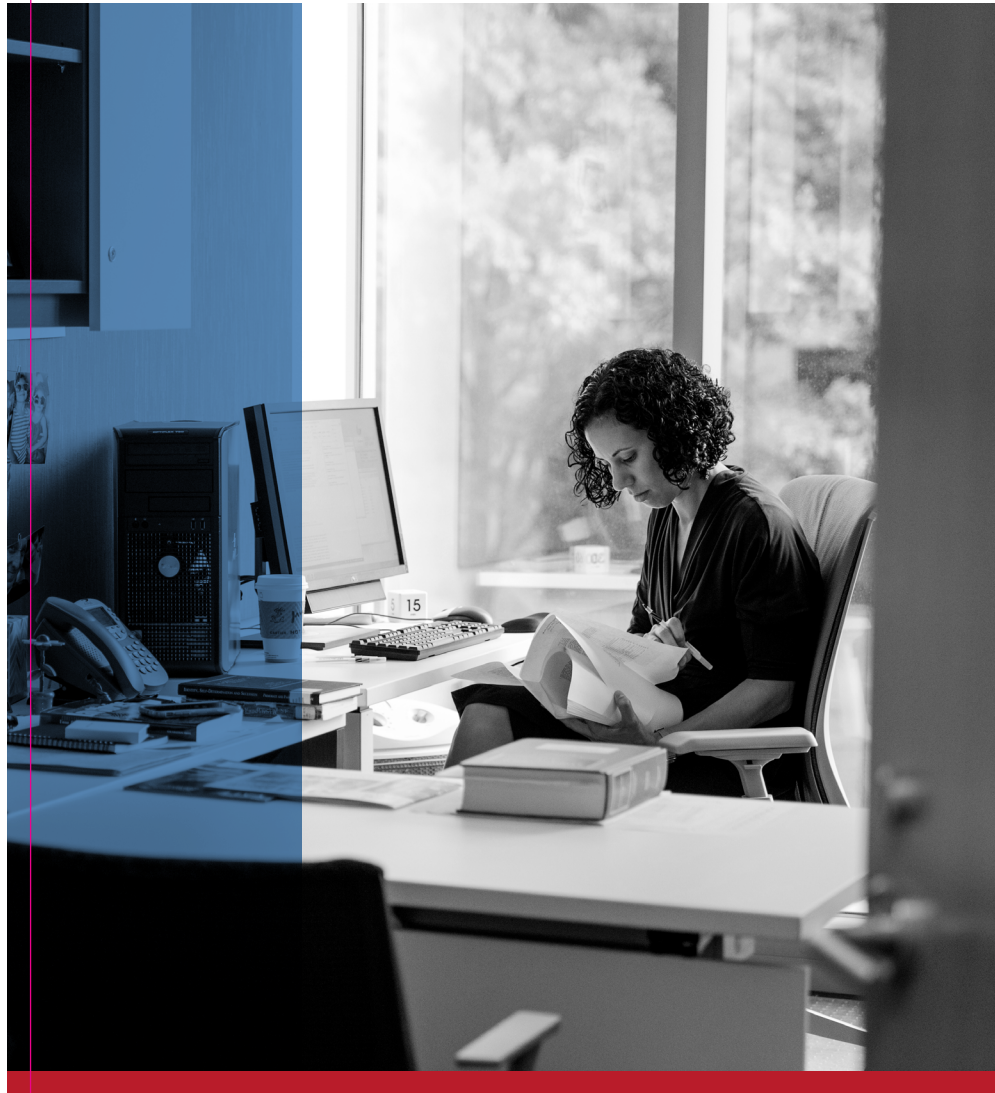

Located in the heart of the Southeast's busiest city, Georgia State Law's myriad centers work to improve the community, region and world around them. Learn more about how you can get involved with our centers and their work.

Our Centers

Center for Access to Justice

Created to shine a light on the specific obstacles to access facing lower-income people in the South the center convenes regional stakeholders – including academic, legal practitioners, government actors, and other policymakers – committed to increasing access to justice. law.gsu.edu/A2J

Center for the Comparative Study of Metropolitan Growth

The center brings together a professional network of lawyers, planners and engineers who are committed to finding sustainable answers to urban growth challenges. Research and programming focuses on urban planning, land use, water rights and other aspects of environmental law, and provides special opportunities for students to participate in comparative study programs in Brazil and other partner institutions around the world. law.gsu.edu/metrogrowth

Center for Intellectual Property

An engaged alumni advisory board of intellectual property practitioners partners with college faculty and community leaders to develop programs for mentoring, scholarships, writing competitions and job fairs for students interested in pursuing intellectual property. law.gsu.edu/ip

Center for Law, Health & Society

Guiding the college's No. 7 ranked health law program, the center aims to improve public health through engaging educational programs, advocacy and community outreach initiatives. The center advances the key role that law plays in promoting the health of individuals, families and communities. clhs.law.gsu.edu

Consortium on Negotiation and Conflict Resolution

The consortium is an inter-institutional, multidisciplinary program for the development of theory and practice in conflict management and resolution. It provides resources to communities like the Ombuds Network of the University System of Georgia and to practitioners of restorative justice. law.gsu.edu/cncr

National Institute for Teaching Ethics and Professionalism

The institute is a consortium of seven centers of research on ethics and professionalism that sponsors several workshops throughout the year, and maintains the International Forum on Teaching Ethics and Professionalism, a database of resources for ethics professors, scholars and practitioners. law.gsu.edu/niftep

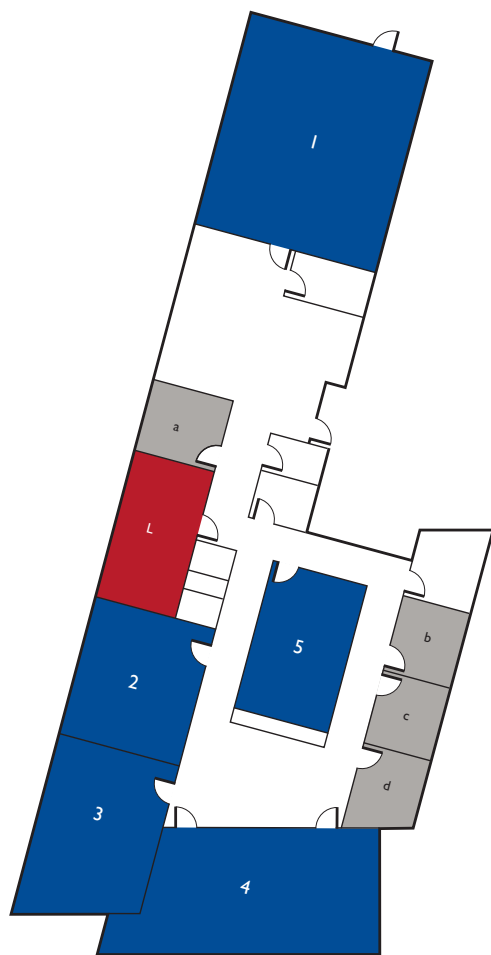

1. Hearing Room 1
 2. Hearing Room 2
 3. Hearing Room 3
 4. Hearing Room 4
 5. Hearing Room 5
- a. Breakout Room A
 - b. Breakout Room B
 - c. Breakout Room C
 - d. Breakout Room D
- L. Neutrals Lounge

Learn more at atlciam.org

Atlanta Center for International Arbitration and Mediation

Located in the Georgia State University College of Law building in downtown Atlanta, the center is only 17 kilometers (10 miles) (20-30 minutes by taxi and 30-40 minutes by train) from the Atlanta Hartsfield-Jackson International Airport. Atlanta's premier-class downtown hotels are only a short walk away.

The center features:

- A high-tech hearing facility for the global dispute resolution community
- Thought leadership and continuing education pertaining to international commercial dispute resolution.
- Hearing rooms accommodating from four to 200 persons
- Breakout rooms and office space for visitors
- The world-class Georgia State Law Library
- Concierge providing meals, couriers, copy, clerical service
- IT support

ARBITRATION
CENTER



ATLANTA CENTER
FOR INTERNATIONAL
ARBITRATION
AND MEDIATION

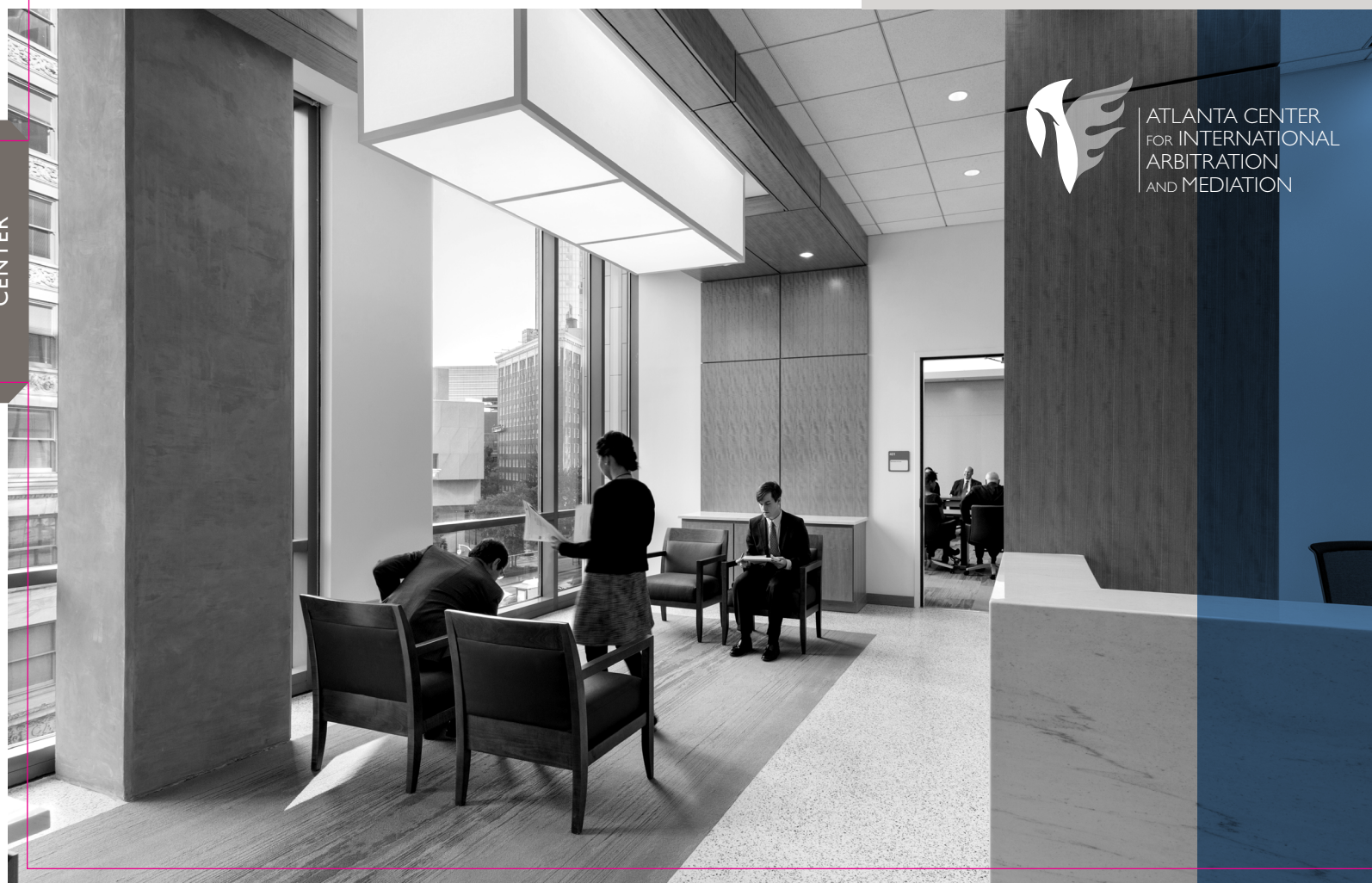

The Externship Program places Georgia State Law students with more than 70 government agencies, nonprofit organizations and judges in Atlanta. Students work in virtually every area of the law and gain great insight into the operation of the legal system and develop a heightened sense of professional responsibility. Students are paired with site-supervising attorneys who work one-on-one with students as they develop their legal skills. They also work throughout the semester with a faculty supervisor who helps guide their learning experience.

"Georgia State Law's Externship Program provided me with the unique opportunity to work with clients and attorneys that I wouldn't have had access to otherwise. It was rewarding not only in an educational capacity, but a professional one as well."

Susan Griffiths (J.D./MBA '17)
Hometown: Atlanta, Georgia
Undergraduate Institution:
University of Alabama

CONTACT: Kendall Kerew
Director, Externship Program
404.413.9030
kkerew@gsu.edu

Becoming an Extern Supervisor

To mentor Georgia State Law externs in your office, you must apply for approval.

Participation Requirements

The program can only consider new sites that meet these minimum criteria:

1. The placement is with a judge, nonprofit organization or governmental agency. We do not place students in private corporations or law firms.
2. At least one attorney, employed at the site, must supervise the extern(s).
3. Because the externship is intended to be a learning experience rather than an employment experience, supervisors must be willing to act as mentors. Often, it requires more time to supervise a student than to complete the work oneself. Supervisors must be willing to provide regular feedback to each extern about work performance and written work product.
4. The work performed by the extern must be legal in nature.

Although agencies that meet the above criteria will be considered, priority will be given to those placements that offer students exposure to fields of law under-represented in the Externship Program.

Highlighted Externship Sites

- ACLU of Georgia* Atlanta Legal Aid Society
- Centers for Disease Control and Prevention
- Offices of District Attorneys, Solicitors & Public Defenders
- Environmental Protection Agency
- Equal Employment Opportunity Commission
- Federal Highway Administration Georgia General Assembly
- Georgia Health Association*
- Internal Revenue Service
- Southern Environmental Law Center*
- Southern Center for Human Rights
- Summer IP Program in Washington, D.C.
- U.S. Attorney's Office, Northern District of Georgia
- U.S. Centers for Disease Control and Prevention
- U.S. Securities & Exchange Commission

* denotes sites for part-time students



Through our award-winning in-house clinics, students represent clients and deepen their knowledge and skills while providing needed legal services to those who cannot afford to pay.

CONTACT: Lisa Bliss Radtke
Associate Dean for Experiential Education

404.413.9131
lbliss@gsu.edu
law.gsu.edu/practice-based-learning

Bankruptcy Assistance & Practice

The Bankruptcy Assistance and Practice Program allows second- and third-year students to work with Atlanta Legal Aid Society and low-income Georgians facing debt crisis, foreclosure and bankruptcy.

The Pro Se Assistance Project (P.A.P.) Volunteer bankruptcy attorneys and students provide free legal guidance through 20-minute consultations to individuals representing themselves in proceedings.

Capital Defender Clinic

Second- and third-year students to assist Office of Georgia Capital Defenders attorneys in all aspects of preparing indigent clients' death penalty cases for trial in each phase of the case.

Fundamentals of Law Practice

Students learn practice skills and ethical decision-making through simulating the work of a small, general practice law firm. Course

work includes simulation exercises and actual client representation in domestic violence cases in Cobb County.

Health Legislation and Advocacy

This two-semester clinic examines the process by which legislation is enacted into state law—including drafting, legislative organization and procedure, ethics and lobbying, and the appropriations process. Students work with a community partner organization or agency on upcoming proposed health-related legislation in the Georgia General Assembly.

HeLP Legal Services Clinic

The HeLP Legal Services Clinic represents the low-income families of children receiving health care services through Children's Healthcare of Atlanta. Students work with clinical faculty and a variety of partners—including medical schools, social workers and public health educators—to hone skills in client interviewing and counseling, case management and other advanced aspects of health-related cases.

Investor Advocacy Clinic

The Investor Advocacy Clinic trains students in arbitration, negotiation and mediation as they work with investors who have suffered losses resulting from broker misconduct and cannot secure private legal representation because of the size of their claim. Students also provide smart investment education to the public.

Landlord – Tenant Mediation Clinic

Students mediate landlord/tenant disputes and other disputes, including cases handled in the State and Magistrate courts; particularly small claim civil issues such as disputes between neighbors, consumers and businesses and creditors and debtors.

Law Volunteer Clinic for Veterans

The Law Volunteer Clinic for Veterans provides free legal assistance to student veterans at Georgia State. Volunteer attorneys assist veterans with most legal issues including veterans' benefits, divorce, wills, landlord/tenant and discharge issues.

Olmstead Disability Rights Clinic

The Olmstead Disability Rights Clinic is a partnership with Atlanta Legal Aid Society's Disability Integration Project. Inspired by advocacy based on the Supreme Court case *Olmstead v. L.C.*, students help clients obtain the assistance they need to live at home instead of in an institution.

Philip C. Cook Low-Income Taxpayer Clinic

Students provide legal representation to low-income individuals during the post-audit stage of their disputes with the Internal Revenue Service. The tax clinic provides professional skills and substantive training on filing status, credits and exemptions, immigration status and collection issues.

Pro Bono Program

Center for Access to Justice's Pro Bono Program connects students with legal volunteer opportunities to address unmet legal needs under the supervision of a practicing attorney to enhance the capacity of the law to do justice.

Urban Fellows

Urban Fellows, an interdisciplinary initiative of the Center for the Comparative Study of Metropolitan Growth, connects graduate students from Georgia State and Georgia Institute of Technology's School of City and Regional Planning to scholars and leading professionals to study and discuss issues related to urban growth.

Georgia State Law Experiential Courses

Our practice-based courses and programs teach students in a traditional classroom setting with a professor, textbooks and case studies while also immersing themselves in real-world client work under the supervision of local volunteer attorneys, many of whom are alumni.

In our realistic simulation courses, students are challenged by new, specially designed course materials that simulate legal cases and problems. Because our students get the chance to practice being lawyers in the classroom, they gain the skills and confidence to be successful in the courtroom or wherever else their careers take them.

- Advanced Evidence
- Advocacy in International Commercial Arbitration
- Alternative Dispute Resolution for Advocates
- Bankruptcy Assistance & Practice Program
- Business Arbitration Practicum
- Civil Pre-Trial Litigation
- Fundamentals of Law Practice
- Health Care Transactional & Regulatory Practicum
- Health Legislation & Advocacy I and II
- Interviewing and Counseling
- Lawyering: Advocacy
- Lawyering: Practice-Ready Writing
- Negotiation
- Partnership & LLC Taxation Lab
- Unincorporated Business Associations

COLLEGE OF LAW

GeorgiaState
University | COLLEGE
OF LAW
law.gsu.edu